



<b>Licence number</b>	L3214/2026/1
<b>Licence holder</b>	K&K United Pty Ltd
<b>ACN</b>	657989485
<b>Registered business address</b>	222/224 Stirling st, Perth
<b>APP number</b>	APP - 0033476
<b>Duration</b>	11/05/2026 to 10/05/2046
<b>Date of issue</b>	11/05/2026
<b>Premises details</b>	Green Tyre Technology 28 Lionel st, Naval base, 6165 Legal description - Lot no. 508 Plan no.3638 Land certificate of title volume 1276. Polio 805

Prescribed premises category description (Schedule 1, Environmental Protection Regulations 1987)	Assessed production / design capacity
<b>Category 57: Used tyre storage (general):</b> premises (other than premises within category 56) on which used tyres are stored.	Up to 600 tyres at any one time
<b>Category 61A: Solid waste facility:</b> premises (other than premises within category 67A) on which solid waste produced on other premises is stored, reprocessed, treated, or discharged onto land.	624 tonnes/year

This licence is granted to the licence holder, subject to the attached conditions, on 11 May 2026, by:

Grace Heydon  
Manager Waste Industries  
an officer delegated under section 20 of the *Environmental Protection Act 1986* (WA)

## Licence history

Date	Reference number	Summary of changes
11/05/2026	L3214/2026/1	Licence granted.

## Interpretation

In this licence:

- (a) the words 'including', 'includes' and 'include' in conditions mean "including but not limited to", and similar, as appropriate;
- (b) where any word or phrase is given a defined meaning, any other part of speech or other grammatical form of that word or phrase has a corresponding meaning;
- (c) where tables are used in a condition, each row in a table constitutes a separate condition;
- (d) any reference to an Australian or other standard, guideline, or code of practice in this licence:
  - (i) if dated, refers to that particular version; and
  - (ii) if not dated, refers to the latest version and therefore may be subject to change over time;
- (e) unless specified otherwise, any reference to a section of an Act refers to that section of the EP Act; and
- (f) unless specified otherwise, all definitions are in accordance with the EP Act.

**NOTE:** This licence requires specific conditions to be met but does not provide any implied authorisation for other emissions, discharges, or activities not specified in this licence.

## Licence conditions

The licence holder must ensure that the following conditions are complied with:

### Infrastructure and equipment

- The licence holder must ensure that the site infrastructure and equipment listed in Table 1 and located at the corresponding infrastructure location is maintained and operated in accordance with the corresponding operational requirement set out in Table 1.

**Table 1: Infrastructure and equipment requirements**

	Site infrastructure and equipment	Operational requirement	Infrastructure location
1.	The bund in southeastern portion of the site.	a) Sealed concrete blocks must be used as the construction material. b) Height of bund wall must be 2m	Appendix Schedule 1,  Figure 2
2.	Bunding around the tyre-storage and shredding warehouse.	a) Sealed concrete blocks must be used as the construction material. b) Height of the bund walls must be 0.5m at both the tyre-storage and at the open borders of the shredding warehouse (ramps). c) Minimum containment capacity for each banded area must be 20.6m <sup>3</sup> for tyre-storages and 132m <sup>3</sup> for the shredding warehouse.	Appendix Schedule 1,  Figure 2
3.	Equipment used for processing waste tyres – Shredder machine	a) Must only be housed and operated inside the warehouse on the premises. b) Must be operated in a manner that ensures noise emissions comply with the <i>Environmental Protection (Noise) Regulations 1997</i> . c) Feeding area must be covered with flexible flippers and output area must be covered with concealed bags. d) Production activities must be carried out in an enclosed area, with vacuum cleaning conducted daily.	Appendix Schedule 1,  Figure 2
4.	Generator	a) Must only be operated during business hours. b) Must be operated in a manner that ensures noise emissions comply with the <i>Environmental Protection (Noise) Regulations 1997</i> .	Appendix Schedule 1,  Figure 2
5.	Stormwater /Fire water containment (Sumps)	a) Sumps must not be connected with sewerage systems. b) Septic tank/ system must be maintained according to <i>Health (Treatment of Sewage and Disposal of Effluent and Liquid Waste) Regulations 1974</i> .	Appendix Schedule 1,  Figure 2

	Site infrastructure and equipment	Operational requirement	Infrastructure location
6.	All on-site fire management and prevention equipment	<p>a) All on-site fire management and prevention equipment to be stored so access is not impeded by infrastructure or equipment used in site operations.</p> <p>b) All on-site fire management and prevention equipment must be maintained in good working order, in accordance with AS 1851, and capable of controlling and extinguishing a waste material fire within the premises.</p> <p>c) Signage at the front of the premises is to be maintained with up-to-date information for first responders, including:</p> <ul style="list-style-type: none"> <li>(i) after hours contact number</li> <li>(ii) location and layout of fire hose reels, hydrants and isolation valve</li> <li>(iii) a list of materials that are accepted at the site</li> </ul> <p>d) Site access points are to be kept clear and maintained to ensure adequate access by emergency response vehicles.</p> <p>e) Fire hose reels to cover the entire premises, including the open yard and internal buildings.</p> <p>f) On-site fire extinguishers must be able to extinguish rubber fires.</p>	<p>Aspect Schedule 1,</p> <p>Figure 2</p>
7.	Warehouse	<p>a) Must be secure at all times to prevent unauthorised access to the building.</p> <p>b) Ground surface must be maintained free of cracks and damages.</p> <p>c) Dust extraction and filtration systems must be fully functional at all times during the operation of the shredding machine and must be maintained as per manufacturers specifications.</p> <p>d) A 1m clearance to be maintained internally within the building along paths of travel to exits and firefighting equipment.</p>	<p>Aspect Schedule 1,</p> <p>Figure 2</p>
8.	External waste tyre storage area	<p>a) Premises must be secure at all times to prevent unauthorised access to the building and storage areas by persons not authorised to be on the premises.</p> <p>b) A perimeter vehicular access clearance of 6m must be clearly marked to allow emergency vehicles to access the waste storage areas during an emergency response.</p> <p>c) Entry / exit points onto the site to be unobstructed and not less than 4m wide to allow emergency services vehicles access to the site.</p> <p>d) Tyres must be stacked on their side; or if stored on their treads, must be suitably contained by a system to prevent rolling.</p> <p>e) Ground surface must be maintained free of cracks</p>	<p>Aspect Schedule 1,</p> <p>Figure 2</p>

	Site infrastructure and equipment	Operational requirement	Infrastructure location
		and damages. f) All waste tyres must be stored in accordance with GN02 as follows: <ul style="list-style-type: none"> <li>(i) Tyre stacks should be no closer than 6m to all buildings on the same allotment having non-combustible external walls.</li> <li>(ii) Tyre stacks must not exceed 3.7 m in height, 60m<sup>2</sup> in area outdoors, 30m<sup>2</sup> indoors and 12.5 tonnes in weight (</li> <li>(iii)</li> <li>(iv) Figure 2)</li> <li>(v) Tyre stacks should be no closer than 18m to all buildings on the same allotment having combustible external walls.</li> <li>(vi) Tyre piles must be separated by a minimum of 2.5m.</li> <li>(vii) A minimum clearance distance of 1 metre must be maintained along paths of travel to required exits and to firefighting equipment and be unobstructed at all times.</li> </ul>	

## Waste acceptance and processing

### Waste acceptance

2. The licence holder must only accept onto the premises waste of a type that:
- (a) does not exceed the rate at which that waste is received; and
  - (b) meets the relevant acceptance specification,
- as set out in Table 2.

**Table 2: Waste acceptance criteria**

Waste type	Rate at which waste is received	Acceptance specification
Used tyres	Up to 624 tonnes per annual period	<ul style="list-style-type: none"> <li>a) Whole, unburnt tyres only.</li> <li>b) Must not allow the number of used tyres on the premises to exceed 600 tyres at any one time.</li> </ul>

**Note 1:** Additional requirements for the acceptance of controlled waste (including tyres) are set out in the Environmental Protection (Controlled Waste) Regulations 2004.

**Note 2:** Additional requirements for calculating the number of used tyres are set out in the Environmental Protection Regulations 1987.

3. Where waste does not meet the waste acceptance criteria set out in condition 2, the licence holder must:
- (a) reject the waste.
  - (b) record the details of the:
    - (i) waste (type and description)

Department of Water and Environmental Regulation

- (ii) source of the waste load
  - (iii) name of the waste carrier
  - (iv) registration number of the delivery vehicle
  - (v) date that the waste load was rejected.
- (c) maintain accurate and auditable records of all waste loads rejected from the premises.
4. The licence holder must ensure that where waste does not meet the waste acceptance criteria set out in condition 3, it is removed from the premises by the delivery vehicle or, where that is not possible, stored in a quarantined storage area or container and removed to an appropriately authorised facility as soon as practicable.

**Waste Processing**

5. The licence holder must ensure that the waste types specified in Table 3 are only subjected to the corresponding processes, subject to the corresponding process limits and/or specifications.

**Table 3: Waste processing**

Waste type	Process(es)	Process limits and/or specifications
Used tyres	Receipt, handling, shredding	<ul style="list-style-type: none"> <li>a) Tyre shredding to occur within the warehouse only.</li> <li>b) No more than 624 tonnes of tyres and rubber pieces are to be processed per annual period.</li> <li>c) Shredded tyres must be free of tyre remains subjected to fire, oil, grease, petrol and diesel fuels, fibrous organic matter or other material that could create a fire hazard.</li> <li>d) Tyres shred must not be larger than 150 mm in any direction, and must not be smaller than 100 mm in any direction.</li> <li>e) Shredded tyres are not permitted to be stored within the warehouses.</li> <li>f) All shredded material must be placed immediately into concealed bags upon processing and then loaded directly onto the delivery trucks.</li> </ul>

**Note 1:** Additional requirements for calculating the number of used tyres are set out in the Environmental Protection Regulations 1987.

6. The licence holder must ensure that operations at the premises only occur between the hours of 07:00 to 18:00, and on the days of Monday through to Friday, and 07:00 to 13:00 on Saturdays, excluding public holidays.

**Emissions and discharges**

**Spills of environmentally hazardous materials**

7. The licence holder must immediately recover, or remove and dispose of, spills of environmentally hazardous materials including fuel, oil, or other hydrocarbons, whether inside or outside an engineered containment system.
8. The licence holder must ensure that all material used for the recovery, removal, and/or disposal of environmentally hazardous materials is stored in an impermeable container prior to disposal at an appropriately authorised facility.

### Stormwater management

9. The licence holder must take all reasonable and practicable measures to prevent stormwater run-off becoming contaminated by the activities and operations undertaken at the premises.

### Fire and emergency management requirements

10. The licence holder must ensure the fire and emergency management requirements in Table 4 are complied with.

**Table 4: Fire and emergency management requirements**

Requirement for	Fire and emergency management requirements
1. Fire management	a) Maintain, implement and update as required a Fire and Emergency Management Plan for the premises that sets out: <ul style="list-style-type: none"> <li>(i) how fires will be prevented, detected, responded to, suppressed, contained and controlled.</li> <li>(ii) firefighting equipment and fire response capabilities and responsibilities.</li> <li>(iii) a plan showing the location and layout of firefighting equipment and systems at the premises, including the containment infrastructure that will assist during fire management.</li> </ul> (a) No waste is permitted to be burnt on the premises. b) A sufficient number of fire hoses on the premises must be maintained such that all areas of the premises can be reached. c) Any fire on the premises must extinguished as soon as possible.
2. Firewater containment	a) Following a fire incident, lockout tags must be applied to the sump pump to prevent accidental discharge. b) Firewater that may result at the premises from fire-fighting activities must be: <ul style="list-style-type: none"> <li>(i) contained on the premises within the capacity of hardstand and low permeability infrastructure; and</li> <li>(ii) not allowed to escape to the premises, adjacent premises or exposed soil areas.</li> </ul> c) Arrangements must exist for the removal of firewater, in excess of the containment capacity, by a carrier licensed under <i>the Environmental Protection (Controlled Waste) Regulations 2004</i> , to ensure firewater does not discharge to the environment. d) All accumulated and recoverable firewater and other waste that may result from firefighting on the premises is collected and removed within 24-hours of a fire event by a carrier licensed under the <i>Environmental Protection (Controlled Waste) Regulations 2004</i> .

**Note 1:** Notification requirements may include advising the Department of Fire and Emergency Services, Western Australian Police, Ambulance Services, the Department of Water and Environmental Regulation and neighbouring premises.

### Monitoring

11. The licence holder must record the total amount of waste accepted onto the premises, for each waste type listed in Table 5, in the corresponding unit, and for each corresponding time period, as set out in Table 5.

**Table 5: Waste accepted to the premises**

Waste type	Unit	Frequency
Used tyres	Tonnes	Each load accepted at the premises.
	Number of used tyres in the load <sup>1</sup>	
	Number of used tyres on the premises <sup>1</sup>	

**Note 1:** Additional requirements for calculating the number of used tyres are set out in the Environmental Protection Regulations 1987.

- 12.** The licence holder must record the total amount of waste removed from the premises, for each waste type listed in Table 6, in the corresponding unit, and for each corresponding time period set out in Table 6.

**Table 6: Waste removed from the premises**

Waste type	Unit	Frequency
Tyre shred	Tonnes	Each load leaving the premises.
Non-conforming material	Kilograms	Each load leaving the premises.

## Records and reporting

### Records

- 13.** The licence holder must record the following information in relation to complaints received by the licence holder (whether received directly from a complainant or forwarded to them by the Department or another party) about any alleged emissions from the premises:
- (a) the name and contact details of the complainant, (if provided);
  - (b) the time and date of the complaint;
  - (c) the complete details of the complaint and any other concerns or other issues raised; and
  - (d) the complete details and dates of any action taken by the licence holder to investigate or respond to any complaint.
- 14.** The licence holder must maintain accurate and auditable books including the following records, information, reports, and data required by this licence:
- (a) the calculation of fees payable in respect of this licence;
  - (b) the works conducted in accordance with condition 1 of this licence;
  - (c) any maintenance of infrastructure that is performed in the course of complying with condition 1 of this licence;
  - (d) monitoring programmes undertaken in accordance with conditions 11 and 12 of this licence; and
  - (e) complaints received under condition 13 of this licence.
- 15.** The books specified under condition 14 must:
- (a) be legible;

Department of Water and Environmental Regulation

- (b) if amended, be amended in such a way that the original version(s) and any subsequent amendments remain legible and are capable of retrieval;
- (c) be retained by the licence holder for the duration of the licence; and
- (d) be available to be produced to an inspector or the CEO as required.

**Reporting**

**16.** The licence holder must immediately notify the CEO of:

- (a) any fire on the premises; and/or
- (b) any accident, malfunction, or emergency which results or could result in the discharge of fire-fighting wash water or other wastes from the premises.

**17.** The licence holder must:

- (a) undertake an audit of their compliance with the conditions of this licence during the preceding annual period, and
- (b) prepare and submit to the CEO an Annual Audit Compliance Report in the approved form by March 1 each year.

## Definitions

In this licence, the terms in 7 have the meanings defined.

**Table 7: Definitions**

Term	Definition
ACN	Australian Company Number
Annual Audit Compliance Report (AACR)	means a report submitted in a format approved by the CEO (relevant guidelines and templates are available on the Department's website).
annual period	a 12 month period commencing from 1 January until 31 December of the immediately following year.
AS 1851	means Standards Australia AS 1851 Maintenance of Fire Protection Systems and Equipment
books	has the same meaning given to that term under the EP Act.
CEO	means Chief Executive Officer of the department. "submit to / notify the CEO" (or similar), means either: Director General Department administering the <i>Environmental Protection Act 1986</i> Locked Bag 10 Joondalup DC WA 6919 or: <a href="mailto:info@dwer.wa.gov.au">info@dwer.wa.gov.au</a>
department; DWER	means the department established under section 35 of the <i>Public Sector Management Act 1994</i> (WA) and designated as responsible for the administration of the EP Act, which includes Part V Division 3.
discharge	has the same meaning given to that term under the EP Act.
emission	has the same meaning given to that term under the EP Act.
EP Act	<i>Environmental Protection Act 1986</i> (WA)
EP Regulations	<i>Environmental Protection Regulations 1987</i> (WA)
Firewater	means water that, in the event of a fire, has been used to extinguish a fire, and all materials and combusting products dissolved or suspended within such water, and includes other fire suppressant substances such as foams.
GN02	means <i>the Department of Fire and Emergency Services Guidance Note:GN02 Bulk Storage of Rubber Tyres Including Shredded and Crumbed Tyres.</i>
licence	refers to this document, which evidences the grant of a licence by the

Term	Definition
	CEO under section 57 of the EP Act, subject to the specified conditions contained within.
licence holder	refers to the occupier of the premises, being the person specified on the front of the licence as the person to whom this licence has been granted.
pile	relating to tyre storage, refers to a group of 4 tyre stacks separated by a minimum of 2.5m (as shown in, Figure 2).
premises	refers to the premises to which this licence applies, as specified at the front of this licence and as shown on the premises map (Figure 1) in Schedule 1 to this licence.
prescribed premises	has the same meaning given to that term under the EP Act.
stack	relating to tyre storage, refers to a grouping of tyres not exceeding 3.7m in height, 60m <sup>2</sup> in area and/or 12.5 tonnes in weight.
waste	has the same meaning given to that term under the EP Act.

---

**END OF CONDITIONS**

## Schedule 1: Maps

### Premises map

The boundary of the prescribed premises is shown in the map below (Figure 1).



Figure 1: Map of the boundary of the prescribed premises

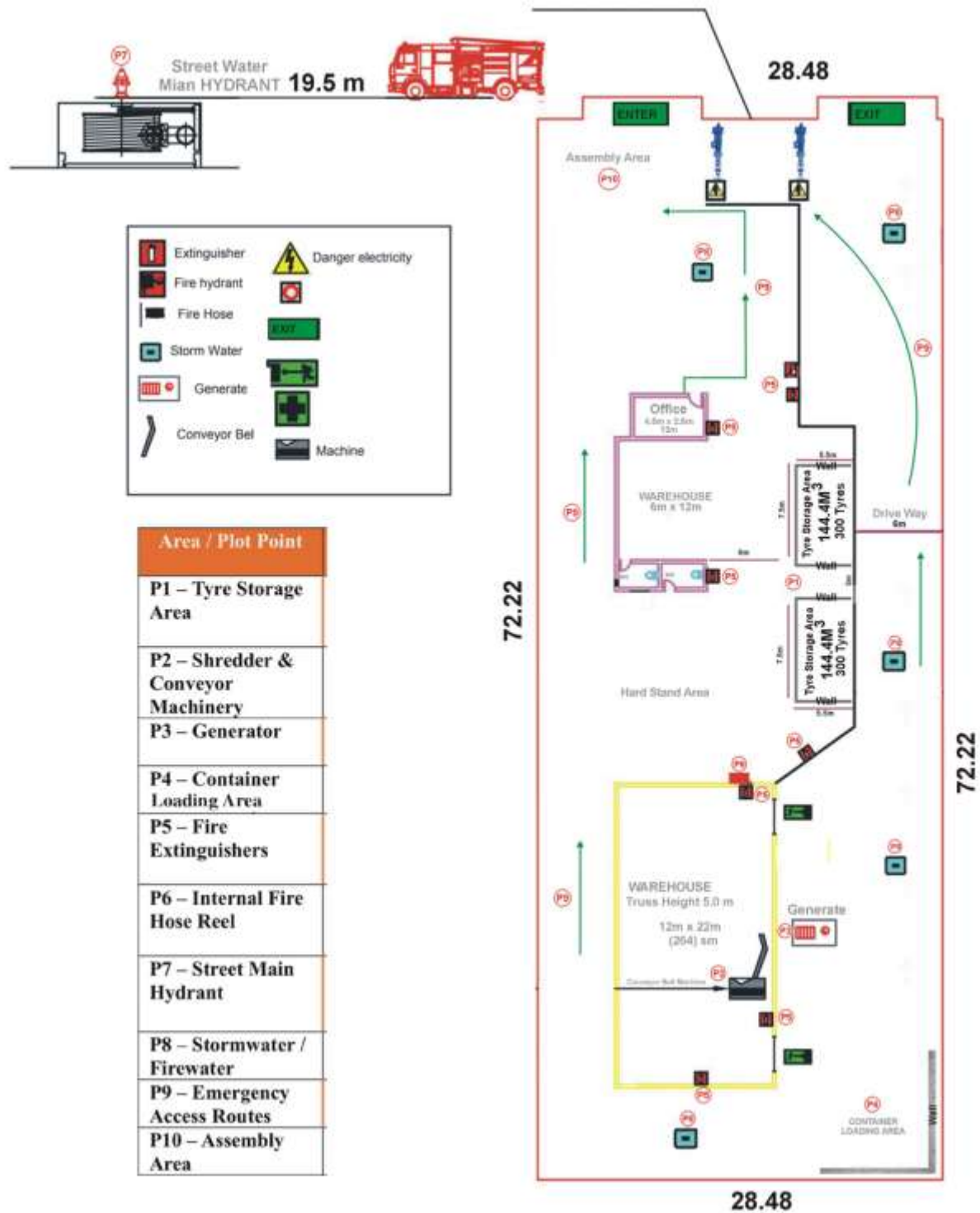

**Figure 2: Site layout**

## Schedule 2: Premises boundary

The corners of the premises boundary are the coordinates listed in Table 8.

**Table 8: Premises boundary coordinates (GDA2020)**

	<b>Easting</b>	<b>Northing</b>	<b>Zone</b>
1.	385492.33186	6437196.26226	50
2.	385520.77953	6437196.23763	50
3.	385492.35754	6437124.05465	50
4.	385520.78885	6437124.06130	50